

ORANGEVILLE

FOR LEASE

70 Centennial Rd. Unit 3

MLS# W5149386

Unit Size:	10,500 Sq.Ft.
Office Area:	500 Sq. Ft.
Shipping:	1 TL & 1 DI Combo
Zoning:	Ind M1
Sprinkler:	Yes
Clear Height:	16'
Heating:	Radiant
Power:	100 Amp 600 Volts
Net Rent:	\$7.95 psf
TMI:	\$2.70 (2021)
Possession:	TBD

- **Great space in the heart of Orangeville**
- **Easy access to Hwy 10 & 410**
- **Clear Span 70ft**
- **Combination Shipping**
- **Clean Uses only**
- **Low TMI**

ANTHONY REALE
Broker of Record
416.630.5577 ext 3
areale@trebnet.com

TRACEY REALE
Sales Representative
416.630.5577 ext 2
tracey@realcor.net

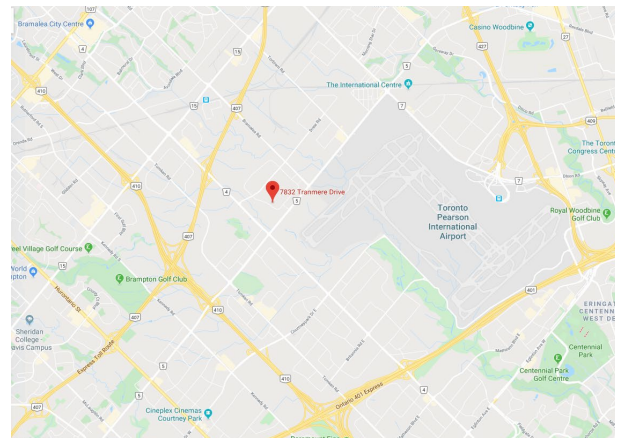
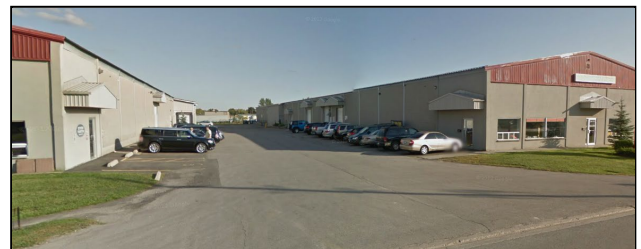

Statements and information contained herein are based upon information furnished by the Principals and Sources which we deem reliable - for which we can assume no responsibility, but which we believe to be correct. This submission is made subject to prior consummation, change in price or terms, errors, omission, or withdrawal from the market without notice.

Realcor Commercial Realty Inc.

**31 Tomlin Crescent
Richmond Hill, Ontario, L4C 7T4**

Tel: 416-630-5577

www.realcor.net

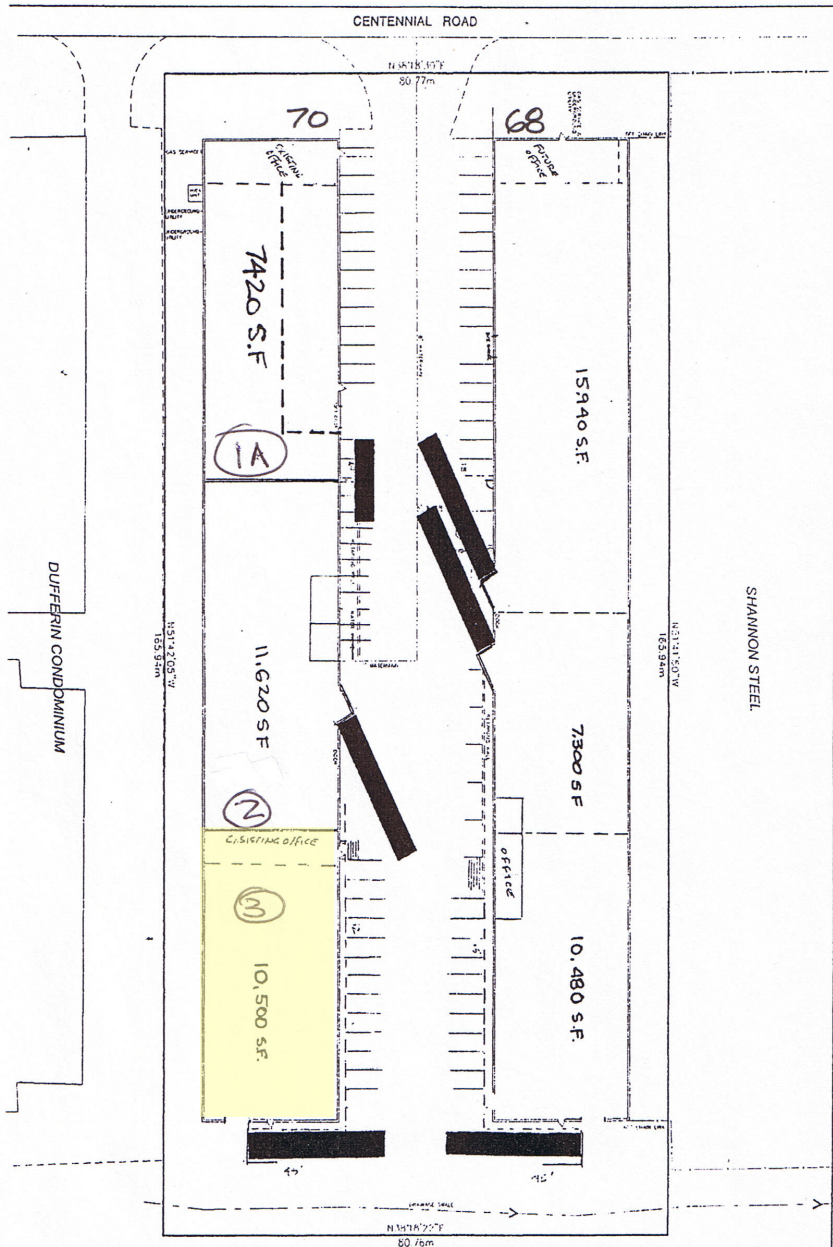

68 & 70 CENTENNIAL ROAD
 Lot 18 and Part of Lot 12
 Register's Conveyance Plan No. 338
 Shire of Orangeville
 Town of Orangeville
 County of Dufferin

EXISTING SITE PLAN
 SCALE: 1" = 10'

NOTES
 1. THIS PLAN IS A REVISION OF THE ORIGINAL PLAN.
 2. THE ORIGINAL PLAN IS FILED IN THE OFFICE OF THE REGISTER OF DEEDS.
 3. THE ORIGINAL PLAN IS FILED IN THE OFFICE OF THE REGISTER OF DEEDS.
 4. THE ORIGINAL PLAN IS FILED IN THE OFFICE OF THE REGISTER OF DEEDS.
 5. THE ORIGINAL PLAN IS FILED IN THE OFFICE OF THE REGISTER OF DEEDS.
 6. THE ORIGINAL PLAN IS FILED IN THE OFFICE OF THE REGISTER OF DEEDS.
 7. THE ORIGINAL PLAN IS FILED IN THE OFFICE OF THE REGISTER OF DEEDS.
 8. THE ORIGINAL PLAN IS FILED IN THE OFFICE OF THE REGISTER OF DEEDS.
 9. THE ORIGINAL PLAN IS FILED IN THE OFFICE OF THE REGISTER OF DEEDS.
 10. THE ORIGINAL PLAN IS FILED IN THE OFFICE OF THE REGISTER OF DEEDS.